

vifa

**STOCKHOLM**  
*mounting wall bracket*

*ENGLISH*

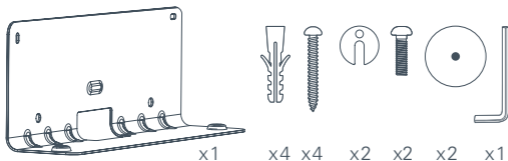

## 1. IN THE BAGS

- 1 x Wall bracket with built-in spirit level  
(In the Stockholm main box)
- 4 x Wall plugs for concrete/ brick wall
- 4 x Screws
- 2 x Adjustment washers
- 2 x Screws for mounting speaker
- 2 x Covers for screws
- 1 x Allen key



### **IMPORTANT INFORMATION**

*It is important when installing wall mount that the installation follow local safety codes, and safe installation practices. In the event there is question to safe installation Vifa strongly suggests to seek the assistance of a professional installer. Vifa does not take responsibility for improper installation of the wall mount.*

### **WARNING NOTICE**

*This procedure is not intended for use on Dry installations*

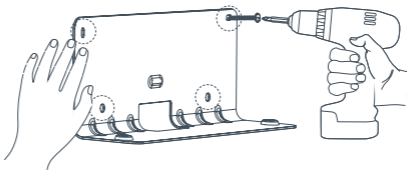
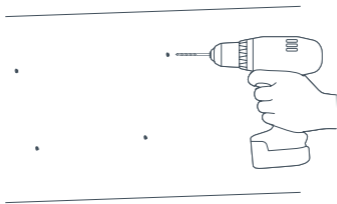
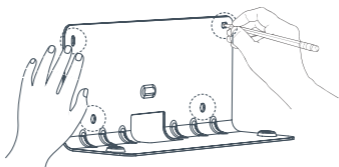

## **2. MARK THE HOLES**

- Place the wall bracket in the desired position and mark the holes with a pencil on the wall.
- Use the spirit leveller to make sure the wall bracket is positioned horizontally.

## **3. DRILL HOLES AND INSERT PLUGS**

- Drill the four holes with an appropriate 10 mm drill.
- Insert the wall plugs.

## **4. POSITION AND SCREW**

- Place the wall bracket and insert the screws with a screwdriver.
- Leave 2-3 mm for the adjustment washers by the two screws at the bottom

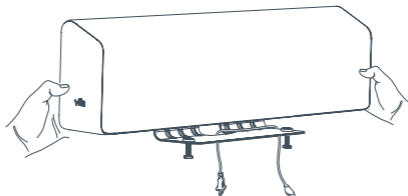
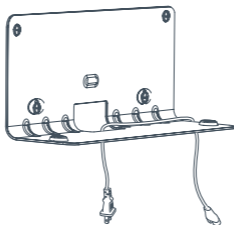
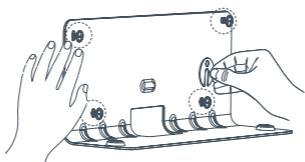

## **5. LEVEL AND ADJUST**

- Place the adjustment washers between the wall bracket and the two screws at the bottom.
- Make sure the wall bracket is positioned horizontally.
- Use the built-in spirit level on the wall bracket.
- Tighten the screws.

## **6. CABLE FOR STOCKHOLM**

- Place the power cable and other cables in the wall bracket.

## **7. MOUNT STOCKHOLM**

- Lift and place the STOCKHOLM, plug in the cables and mount screws in the bottom - we recommend two people for this step.
- Fasten the screws - using the Allen key.
- Put on the screw covers.

For more information please visit our website at  
[www.vifa.dk](http://www.vifa.dk)