

vifa

**STOCKHOLM**  
*mounting wall bracket*

*ENGLISH*

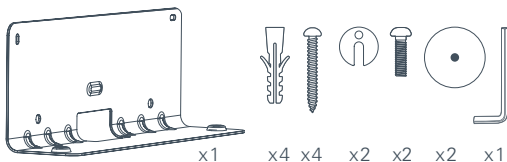

## 1. IN THE BAGS

- 1 x Wall bracket with built-in spirit level  
(In the Stockholm main box)
- 4 x Wall plugs for concrete/ brick wall
- 4 x Screws
- 2 x Adjustment washers
- 2 x Screws for mounting speaker
- 2 x Covers for screws
- 1 x Allen key

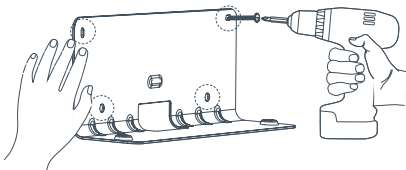
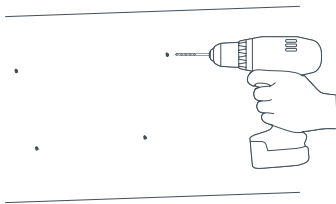
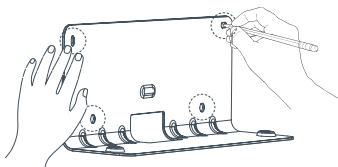

## **2. MARK THE HOLES**

- Place the wall bracket in the desired position and mark the holes with a pencil on the wall.
- Use the spirit leveller to make sure the wall bracket is positioned horizontally.

## **3. DRILL HOLES AND INSERT PLUGS**

- Drill the four holes with an appropriate 10 mm drill.
- Insert the wall plugs.

## **4. POSITION AND SCREW**

- Place the wall bracket and insert the screws with a screwdriver.
- Leave 2-3 mm for the adjustment washers by the two screws at the bottom

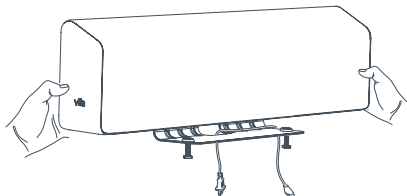
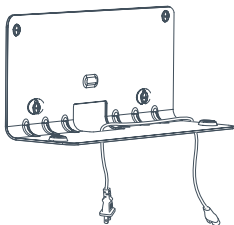
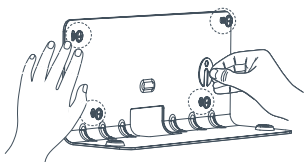

## **5. LEVEL AND ADJUST**

- Place the adjustment washers between the wall bracket and the two screws at the bottom.
- Make sure the wall bracket is positioned horizontally.
- Use the built-in spirit level on the wall bracket.
- Tighten the screws.

## **6. CABLE FOR STOCKHOLM**

- Place the power cable and other cables in the wall bracket.

## **7. MOUNT STOCKHOLM**

- Lift and place the STOCKHOLM, plug in the cables and mount screws in the bottom - we recommend two people for this step.
- Fasten the screws - using the Allen key.
- Put on the screw covers.

For more information please visit our website at  
[www.vifa.dk](http://www.vifa.dk)