

vifa

# COPENHAGEN 2.0

*Snabbguide - modell: VIFA012*

*SVENSKA*

# IMPORTANT STATEMENTS:

This device complies with Part 15 of the FCC Rules. Its operation is subject to the following two conditions:

1. This device may not cause harmful interference, and
2. This device must accept any interference received, including interference that may cause undesired operation.

Cet appareil est conforme à la section 15 des réglementations de la FCC. Le fonctionnement de l'appareil est sujet aux deux conditions suivantes:

1. Cet appareil ne doit pas provoquer d'interférences néfastes, et
2. Cet appareil doit tolérer les interférences reçues, y compris celles qui risquent de provoquer un fonctionnement indésirable.

## Note:

This product has been tested and found to comply with the limits for a Class B digital device, pursuant to Part 15 of the FCC Rules. These limits are designed to provide reasonable protection against harmful interference in a residential installation. This product generates, uses, and can radiate radio frequency energy and, if not installed and used in accordance with the instructions, may cause harmful interference to radio communications.

However, there is no guarantee that interference will not occur in a particular installation. If this product does cause harmful interference to radio or television reception, which can be determined by turning the equipment off and on, the user is encouraged to try to correct the interference by one or more of the following measures:

- Reorient or relocate the receiving antenna.
- Increase the separation between the equipment and receiver.
- Connect the equipment into an outlet on a circuit different from that to which the receiver is connected.
- Consult the dealer or an experienced radio/TV technician for help.

Changes or modifications not expressly approved by the party responsible for compliance could void the user's authority to operate the equipment.

This device complies with Industry Canada licence-exempt RSS standard(s). Operation is subject to the following two conditions:

1. This device may not cause interference, and
2. This device must accept any interference, including interference that may cause undesired operation of the device.

Le présent appareil est conforme aux CNR d'Industrie Canada applicables aux appareils radio-exemptés de licence. L'exploitation est autorisée aux deux conditions suivantes:

1. l'appareil ne doit pas produire de brouillage, et
2. l'utilisateur de l'appareil doit accepter tout brouillage radioélectrique subi, même si le brouillage est susceptible d'en compromettre le fonctionnement.

## FCC/IC Radiation Exposure Statement

This equipment complies with FCC/IC RSS-102 radiation exposure limits set forth for an uncontrolled environment. This equipment should be installed and operated with minimum distance 20 cm between the radiator & your body.

Déclaration de la FCC et d'IC sur l'exposition aux radiations  
Cet appareil est conforme à la norme RSS102 de la FCC/IC relative aux limites d'exposition aux radiations dans un environnement non contrôlé. Vous devez installer et utiliser cet appareil en respectant une distance minimale de 20 cm entre votre corps et l'élément rayonnant.

Vifa Denmark A/S  
Mariendalsvej 2A  
DK - 8800 Viborg  
vifa.dk



The maximum ambient temperature should not exceed 40°C.

Vifa Denmark A/S hereby declares that the product Copenhagen 420 (VIFA012), which contains Bluetooth and Wi-Fi radio transceivers, complies with the essential requirements of EU directive 2014/53/EU (RED).

The radiated power for Bluetooth RF frequency range 2402-2480MHz is less than 10dBm.

The radiated power for Wi-Fi RF frequency range 2422-2472MHz is less than 20dBm.

The complete EU Declaration of Conformity can be downloaded from: [www.vifa.dk/support](http://www.vifa.dk/support)

Firmware version:  
Equal or later than System/3.6.4917.206 and BT/1.2

# IMPORTANT SAFETY INSTRUCTIONS

## Regulatory Safety Information

- 1 Read these instructions.
  - 2 Keep these instructions.
  - 3 Heed all warnings.
  - 4 Follow all instructions.
  - 5 Do not use this apparatus near water.
  - 6 Clean only with dry cloth.
  - 7 Do not block any ventilation openings. Install in accordance with the manufacturer's instructions.
  - 8 Do not install near any heat sources such as radiators, heat registers, stoves, or other apparatus (including amplifiers) that produce heat.
  - 9 Do not defeat the safety purpose of the polarized or grounding-type plug. A polarized plug has two blades with one wider than the other. A grounding type plug has two blades and a third grounding prong. The wide blade or the third prong are provided for your safety. If the provided plug does not fit into your outlet consult an electrician for replacement of the obsolete outlet.
  - 10 Protect the power cord from being walked-on or pinched particularly at plugs, convenience receptacles and the point where they exit from the apparatus.
  - 11 Only use attachments/accessories specified by the manufacturer.
  - 12 Use only with the cart, stand, tripod, bracket or table specified by the manufacturer or sold with the apparatus. When a cart is used, use caution when moving the cart/apparatus combination to avoid injury from tip-over.
  - 13 Unplug this apparatus during lightning storms or when unused for long periods of time.
  - 14 Refer all servicing to qualified service personnel. Servicing is required when the apparatus has been damaged in any way, such as power-supply cord or plug is damaged, liquid has been spilled or objects have fallen into the apparatus, the apparatus has been exposed to rain or moisture, does not operate normally or has been dropped.
  - 15 To completely disconnect unit power from the AC mains, disconnect the unit's power cord from the mains socket.
  - 16 Important! This equipment is not intended to be used on soft support (like beddings, Blankets etc.)
  - 17 The socket-outlet shall be easily accessible.
  - 18 Disposal of a battery into fire or a hot oven, or mechanically crushing or cutting of a battery can result in an explosion
  - 19 High or low extreme temperatures that a battery can be subjected to during use is 10°C - 45°C, storage -20°C - 40°C or transportation 10°C - 45°C, and low air pressure is 86-106kPa at 2000m. high altitude.
  - 20 Leaving a battery in an extremely high temperature surrounding environment that can result in an explosion or the leakage of flammable liquid or gas.
  - 21 Battery subjected to extremely low air pressure that may result in an explosion or the leakage of flammable liquid or gas.
  - 22 Product label affixed to the bottom of the product.
  - 23 **CAUTION:** Danger of explosion if battery is incorrectly replaced. Replace only with the same or equivalent type.
  - 24 **WARNING:** The Battery (battery pack or batteries installed) shall not be exposed to excessive heat such as sunshine, fire or the like.
  - 25 **WARNING:** The main plug shall remain readily operable.
  - 26 Keep minimum distances 1cm around the apparatus for sufficient ventilation.
  - 27 The ventilation should not be impeded by covering the ventilation openings with items, such as newspapers, table-cloths, curtains, etc.
  - 28 Attention should be drawn to the environmental aspects of battery disposal.
  - 29 The use of apparatus in tropical and/or moderate climates.
  - 30 Risk of explosion if the battery is replaced by an incorrect type.
- WARNING:**
- To reduce the risk of fire and electric shock do not expose this apparatus to rain or moisture.
  - Do not place objects filled with liquids such as vases on the apparatus.
  - Do not open apparatus. There are no user-serviceable parts inside. Risk of electric shock inside.
  - The apparatus shall not be exposed to dripping or splashing.
  - No naked flame sources, such as lighted candles, such as lighted candles, should be placed on the apparatus.



The lightning flash and arrow head within the triangle is a warning sign alerting you of dangerous voltage inside the product



The exclamation point within the triangle is a warning sign alerting you of important instructions accompanying the product.

## *Du har gjort ett bra val*

Flera rum. Flera användare. Flera källor.  
Copenhagen 2.0 är en del av Vifa®HOME-systemet  
som når varje hörn i ditt hem och ger dig den ultimata ljudupplevelsen.

Njut!

### **COPENHAGEN**

I din låda .....	6
Komma igång.....	7

### **ANSLUTA TILL COPENHAGEN**

Ansluta till Wi-Fi-nätverk .....	8
Ansluta med <i>Bluetooth</i> ® .....	9
Trådbunden anslutning .....	10

### **Vifa®HOME**

Vifa®PLAY.....	11
Paus/Ljud av.....	12
Vifa®LINK .....	13
Fabriksinställningar .....	14
Återställ .....	15
Fjärrkontroll.....	16
Specifikationer .....	17
Varumärken.....	18



Besök [www.vifa.dk/support](http://www.vifa.dk/support) för snabbguide på andra språk

## I DIN LÅDA

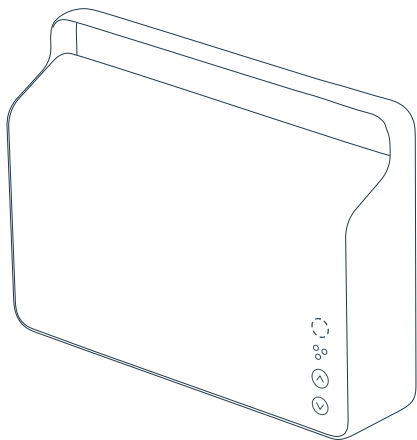

Vifa Copenhagen, strömkabel, minijackkabel AUX 3,5 mm, resefodral, snabbguide och garanti.

## KOMMA IGÅNG

1

Anslut nätsladden till din högtalare och anslut sedan till ett vägguttag.

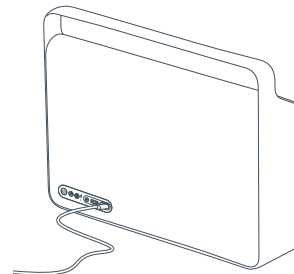

2

Tryck och håll ned POWER-KNAPPEN tills den främre STATUSINDIKATORN tänds och högtalaren slås PÅ. Vänta i upp till 1 minut tills produkten är klar. Detta anges med en ändring från ett snabbt blinkande VITT sken till ett långsamt blinkande VITT sken.

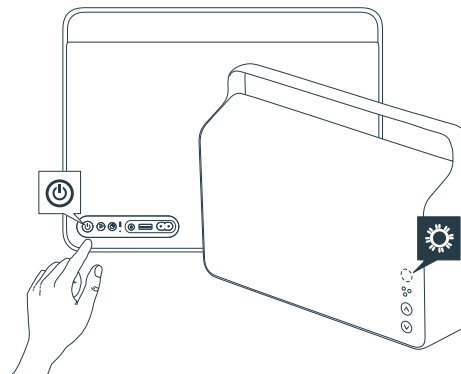

## ANSLUTNING TILL WI-FI-NÄTVERK

Hämta den kostnadsfria Vifa®HOME-appen och följ instruktionerna i appen. Besök [vifa.dk/support](http://vifa.dk/support) om du vill ha mer information om andra möjligheter som t.ex. att använda en dator eller andra enheter vid installationen.

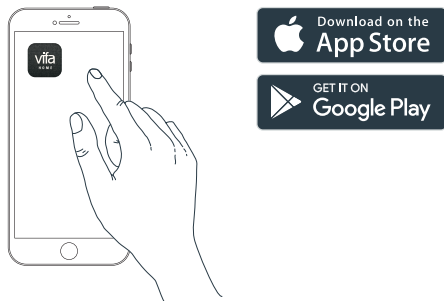

Under installationen ansluter du högtalaren till ditt Wi-Fi-nätverk. Se till att du har lösenordet för ditt Wi-Fi-nätverk redo. När din Copenhagen är ansluten lyser STATUSINDIKATORN med fast VITT sken och du kan börja strömma till dina högtalare.

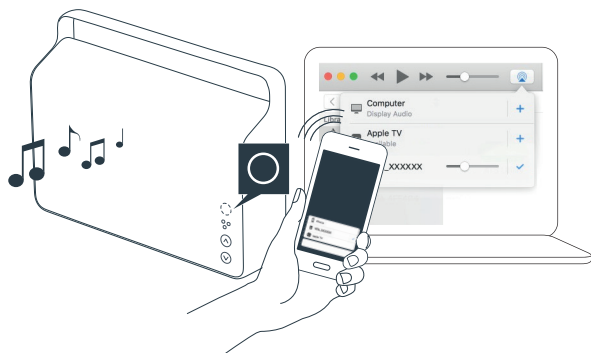

## ANSLUTA MED *BLUETOOTH*®

Tryck kort på CONNECT-knappen och STATUSINDIKATORN blinkar med BLÅTT sken.

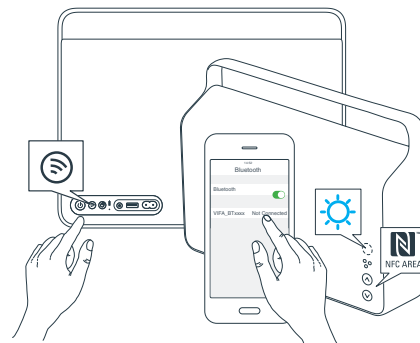

STATUSINDIKATORN lyser med fast BLÅTT sken när uppspelningen börjar.

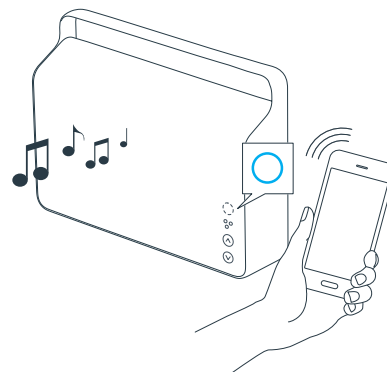

## KABELANSLUTNING

STATUSINDIKATORN lyser med ett fast GRÖNT sken vid uppspelning från en kabelanslutning.

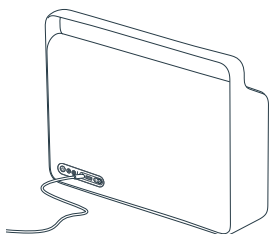

Minijackkabel AUX 3,5 mm  
eller optisk kabel

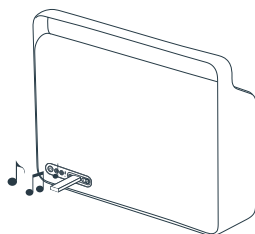

USB-skiva

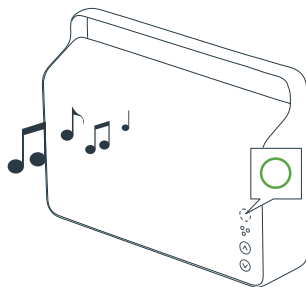

## Vifa®PLAY

Vifa®PLAY-knappen ger dig direktåtkomst till din favoritmusik och dina favoritradiostationer.

Anslut din Copenhagen-högtalare till Wi-Fi-nätverket och håll ned Vifa®PLAY-knappen för att börja strömma de förinställda radiostationerna.

Tryck och håll ned Vifa®PLAY-knappen för att hoppa till nästa förinställda radiostation.

Du kan ändra förinställningen av Vifa®PLAY genom att använda Vifa®HOME-appen.

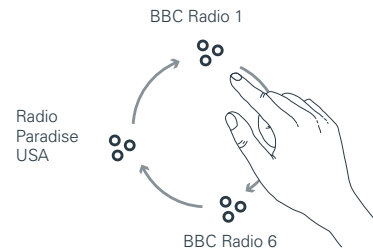
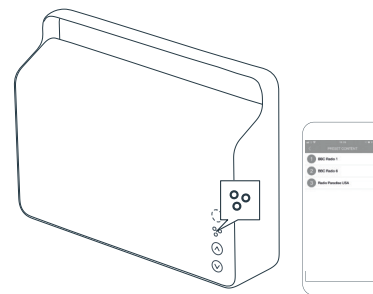

*OBS! De förinställda radiostationerna fungerar bara om Tuneln är tillgänglig i ditt land.*

## PAUS / LJUD AV

Tryck kort på Vifa®PLAY-knappen för Paus/Ljud av.

Tryck kort igen för Spela upp/Ljud på

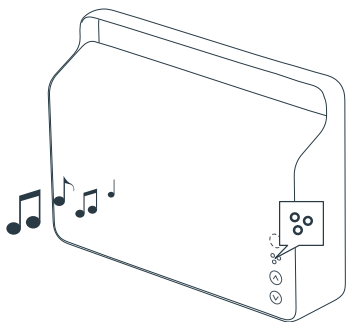

## Vifa®LINK

Vifa®LINK – låter dig koppla ihop olika Vifa®HOME-högtalare med ett diskret klick.

Tryck kort på Vifa®LINK-knappen för att koppla din Copenhagen-högtalare till en annan Vifa®HOME-högtalare.

Tryck och håll ned Vifa®LINK-knappen för att avbryta kopplingen.

För att koppla ihop mer än två Vifa®HOME-högtalare, använd Vifa®HOME-appen.

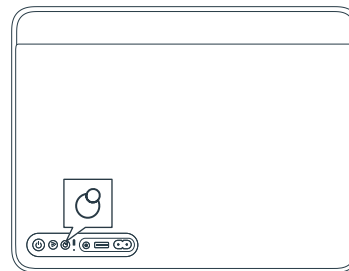

## FABRIKSINSTÄLLNINGAR

Återställer Copenhagens programvara till fabriksinställningarna.

Tryck ned POWER-knappen och CONNECT- knappen samtidigt och håll dem nedtryckta tills STATUSINDIKATORN lyser upp: RÖD - GRÖN - BLÅ. När du släpper knapparna kommer Copenhagen att återställas till fabriksinställningarna – vid återställning till fabriksinställningar kommer:

ALLA ANVÄNDARINSTÄLLNINGAR ATT FÖRSVINNA.

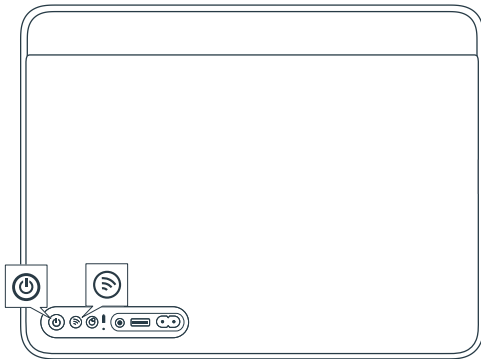

## ÅTERSTÄLL COPENHAGEN

Kan utföras om Copenhagen läser sig.

För att återställa Copenhagen trycker du kort på återställningsknappen. Tryck kort på återställningsknappen för att återställa Copenhagen – inga användarinställningar kommer att försvinna.

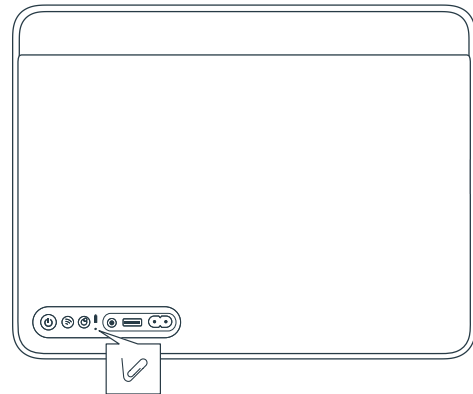



# VIFA R2 FJÄRRKONTROLL - TILLBEHÖR

Vifa R2 fjärrkontroll låter dig enkelt kontrollera din Copenhagen-högtalare från valfri plats i rummet.

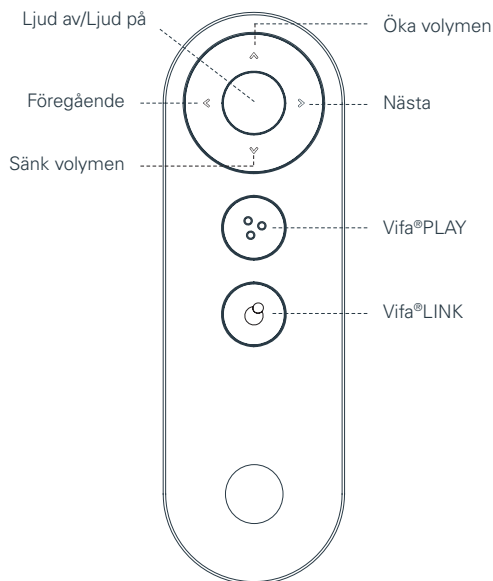

Vifa R2-fjärrkontroll medföljer inte i Copenhagen-lådan.  
Besök: [vifa.dk/shop](http://vifa.dk/shop) om du vill ha mer information om var du köper Vifa R2 fjärrkontroll

# SPECIFIKATIONER

Beskrivning	Vifa®HOME – Copenhagen trådlös högtalare
Tekniska funktioner	Bluetooth® Wireless Technology Qualcomm® aptX™ HD audio Wi-Fi B/G/N, 2,4 GHz Apple AirPlay Fungerar med DLNA DSP-signalbehandling Litiumjonbatteri Force Balanced Woofers 6-kanals högpresterande effektförstärkare
Högtalarelement Diskantregister	2 X 28 mm Vifa-högtalarelement med mjukt, konformat membran och neodymmagnet.
Mellanregister	2 x 50 mm Vifa-högtalarelement med kon i aluminium och neodymmagnet.
Basregister	2 X 80 mm Vifa-högtalarelement i platt sandwich-konstruktion och neodymmagnet. Mekaniskt monterad baksida mot baksida i en effektbalanserad konfiguration som stöds av 2 passiva radiatorer.
Frekvensomfång	50Hz - 20kHz @ +/- 3 dB
Inspänning	100-240V ~ 50/60 Hz
max. Angiven strömförbrukning	160 watt
Strömförbrukning i standbyläge	Mindre än 0,5 watt
Utgång	USB 5 volt/2,1 A
Ingångar	Bluetooth® Wireless Technology Qualcomm® aptX™ HD audio Wi-Fi Direct Stöd för Wi-Fi-nätverk Trådbunden optisk eller analog anslutning (3,5 mm minijack) USB-skiva
Mått höjd/bredd/djup	268 mm/362 mm/90 mm
Nettovikt	4,65 kg
Ram	Formgjutet aluminium i ett stycke
Textil	Specialtillverkad textil från Kvadrat

# REGISTER AND TRADEMARKS

We encourage you to register your product at: [www.vifa.dk/register](http://www.vifa.dk/register)



"Made for iPod", "Made for iPhone", and "Made for iPad" mean that an electronic accessory has been designed to connect specifically to iPod, iPhone, or iPad, respectively, and has been certified by the developer to meet Apple performance standards. Apple is not responsible for the operation of this device or its compliance with safety and regulatory standards. Please note that the use of this accessory with iPod, iPhone, or iPad may affect wireless performance.

AirPlay, iPad, iPhone, iPod, iPod classic, iPod nano, iPod touch, and Retina are trademarks of Apple Inc., registered in the U.S. and other countries. iPad Air, iPad min, and Lighting are trademarks of Apple Inc. In Japan, The trademark "iPhone" is used with a license from Aiphone K.K.

AirPlay works with iPhone, iPad, and iPod touch with iOS 4.3.3 or later, Mac with OS X Mountain Lion or later, and PC with iTunes 10.2.2 or later. Supports iOS 7 or later for setup using Wireless Accessory Configuration.



The Spotify software is subject to third party licenses found here: [www.spotify.com/connect/third-party-licenses](http://www.spotify.com/connect/third-party-licenses).

## LISTEN OUT LOUD WITH SPOTIFY CONNECT

1. Connect your Copenhagen 2.0 to your wifi network
2. Open up the Spotify app on your phone, tablet or laptop using the same wifi network
3. Play a song and select Devices Available.
4. Select your Copenhagen 2.0 and start listening



The Wi-Fi CERTIFIED™ logo is a certification mark of Wi-Fi Alliance®.



The Bluetooth® word mark and logos are registered trademarks owned by Bluetooth SIG, Inc., and any use of such marks by Vifa Denmark A/S is under license. Other trademarks and trade names are those of their respective owners.



Qualcomm aptX HD

Qualcomm is a trademark of Qualcomm Incorporated, registered in the United States and other countries. aptX is a trademark of Qualcomm Technologies International, Ltd., registered in the United States and other countries.



The N-Mark is a trademark or registered trademark of NFC Forum, Inc. in the United States and in other countries.



Google Play and the Google Play logo are trademarks of Google Inc.



Vifa®HOME, Vifa®PLAY, Vifa®LINK and the logos are trademarks of Vifa Denmark A/S.

För mer information, besök vår webbplats på  
[vifa.dk](http://vifa.dk)